

ThermalTrace Technical Data

Wireless temperature monitoring system

Characteristics

- Wireless communication from probes to receiver
- Splash Proof (IP67)
- Real-Time Operation
- Predictive phase for cooking & cooling
- Start/Stop for batches.
- Automatic alarm generation
- Automatic report generation when complete

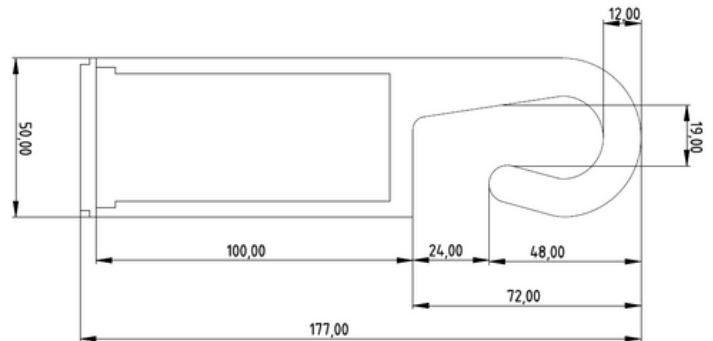

Specifications

Temperature	
Probe Temperature Range	-50 to 130°C
Accuracy	0.15 @ 0°C
Sensor Type	100 ohm class A RTD par din en 60751
General	
Reading rate	1 reading every 3 minutes to 1 reading every 24 hours
Memory	25 000 readings
Start Mode	Start/stop
Calibration	Digital calibration through software
Calibration Rate	Automatically recorded within device
Power	(3) 6V non-rechargeable* *can be replaced by user
Battery life	1 year @ 5 minutes reading intervals
IP Rating	IP67
Data Format	date and time stamped, °C ou °F
Operating System Compatibility	Linux (Ubuntu 22.4)
Operating range	-20 to 125°C
Cable lenght	Customizable
Probe lenght	Customizable
Body Material	P.O.M. polyoxymethylene
Server	
Processor	Intel I7, Ryzen 7 , or equivalent
Memory	16 GB Ram
Hard Drive	Sata SSD 500 GB or plus
Operating System	Linux (Ubuntu)
Wireless	
LoRaWAN 915 Mhz	
Band	902-928 Mhz
Maximum Output Power	Node : Maximum +20dbm Gateway ; Maximum +27dbm
Receiver Sensitivity	Typically -139dbm
Transmission Distance	15 km line of sight



Exceltec Canada Inc.
www.exceltec-inc.com
450 629.4477

Instrumentors Supply Inc. (USA)
www.instrumentors.com
503 656.8605